

View Front side  
1:50

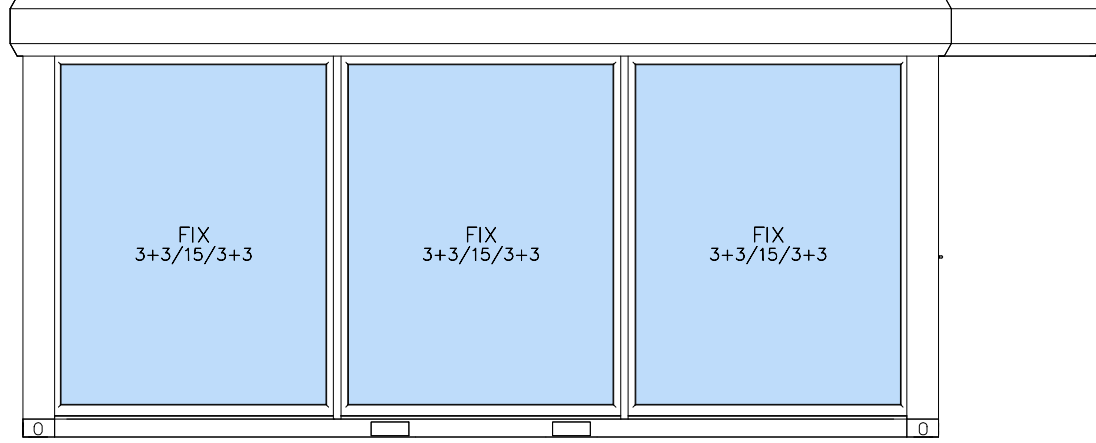

View Back side  
1:50

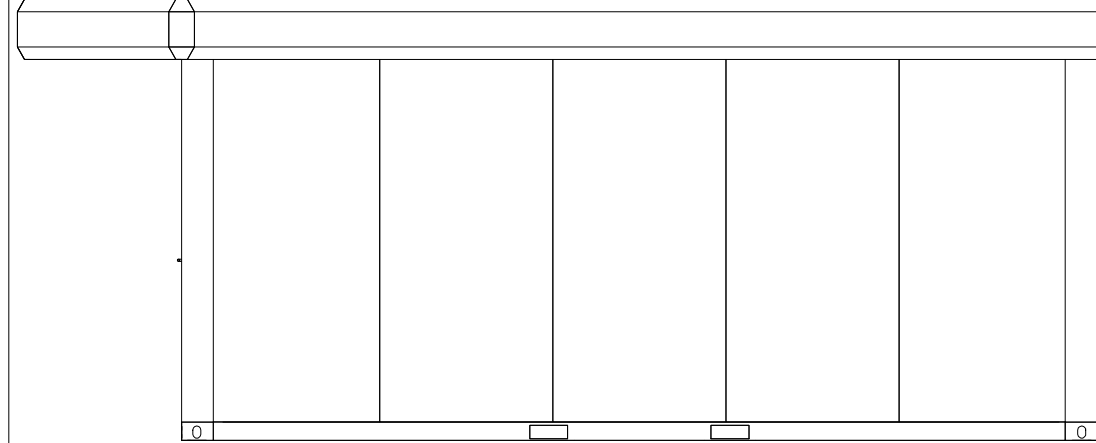

View Left side  
1:50

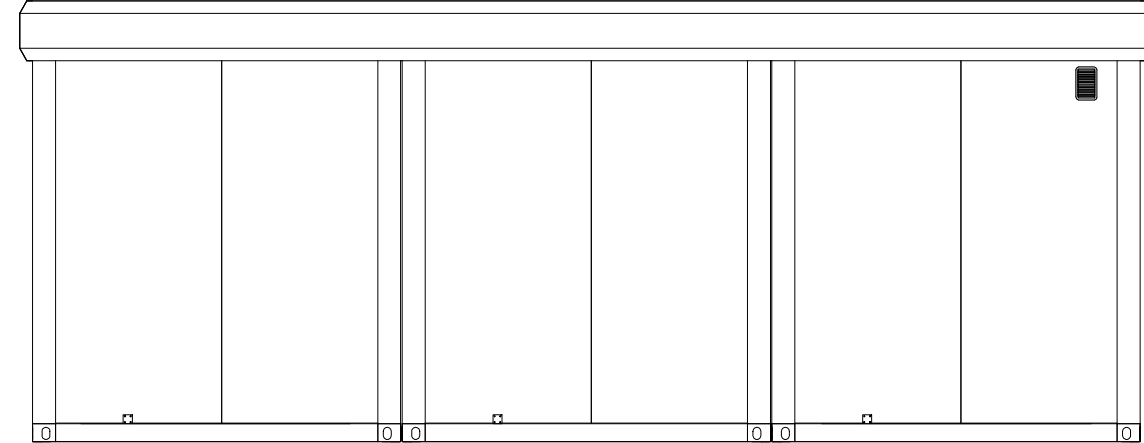

View Right side  
1:50

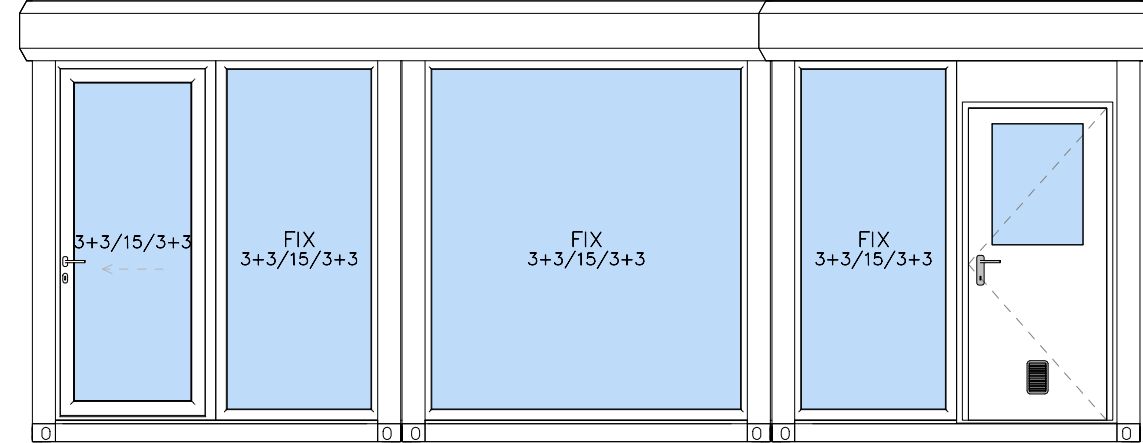

Floor Plan  
1:50

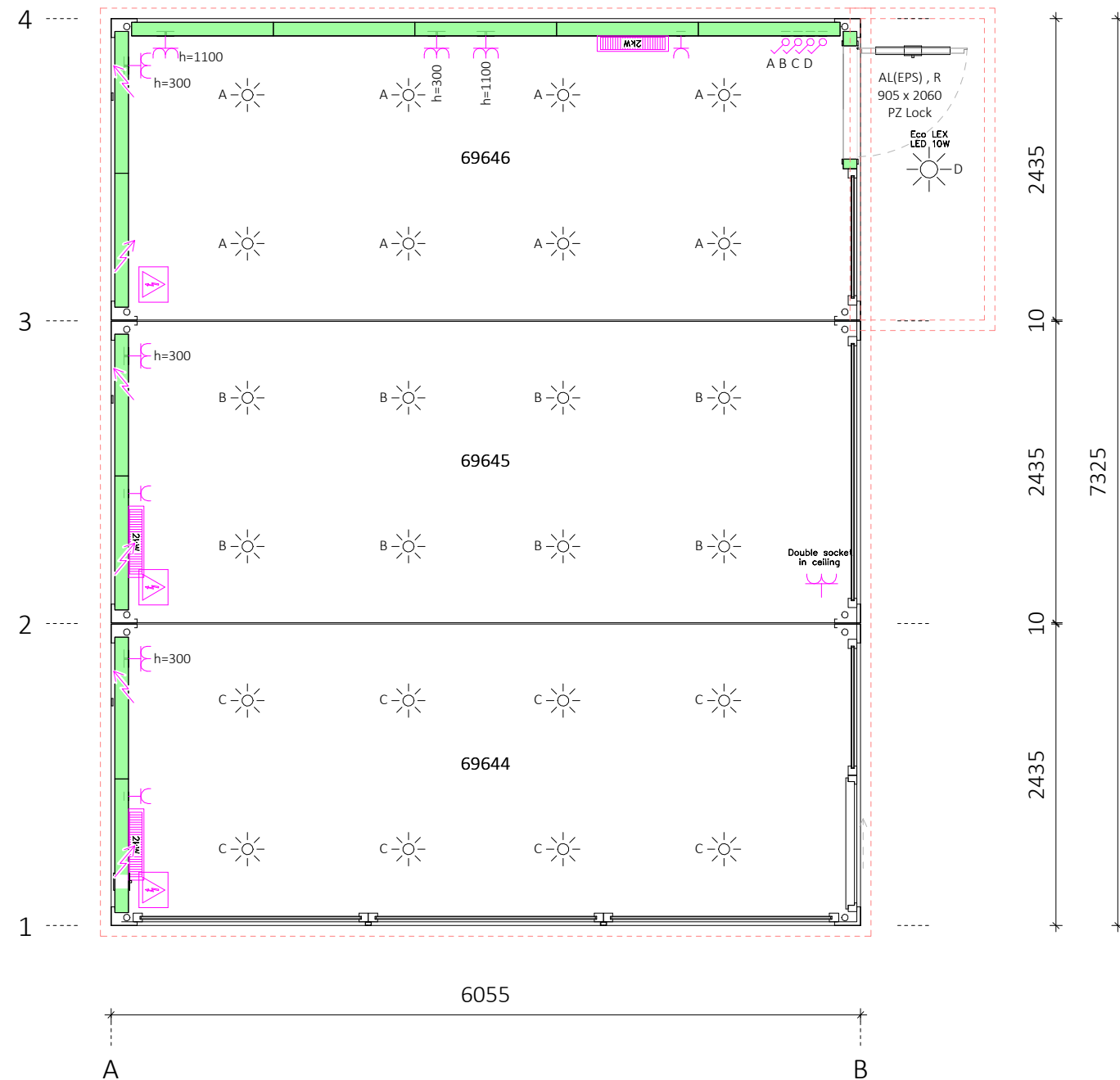

3D

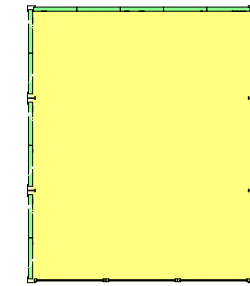
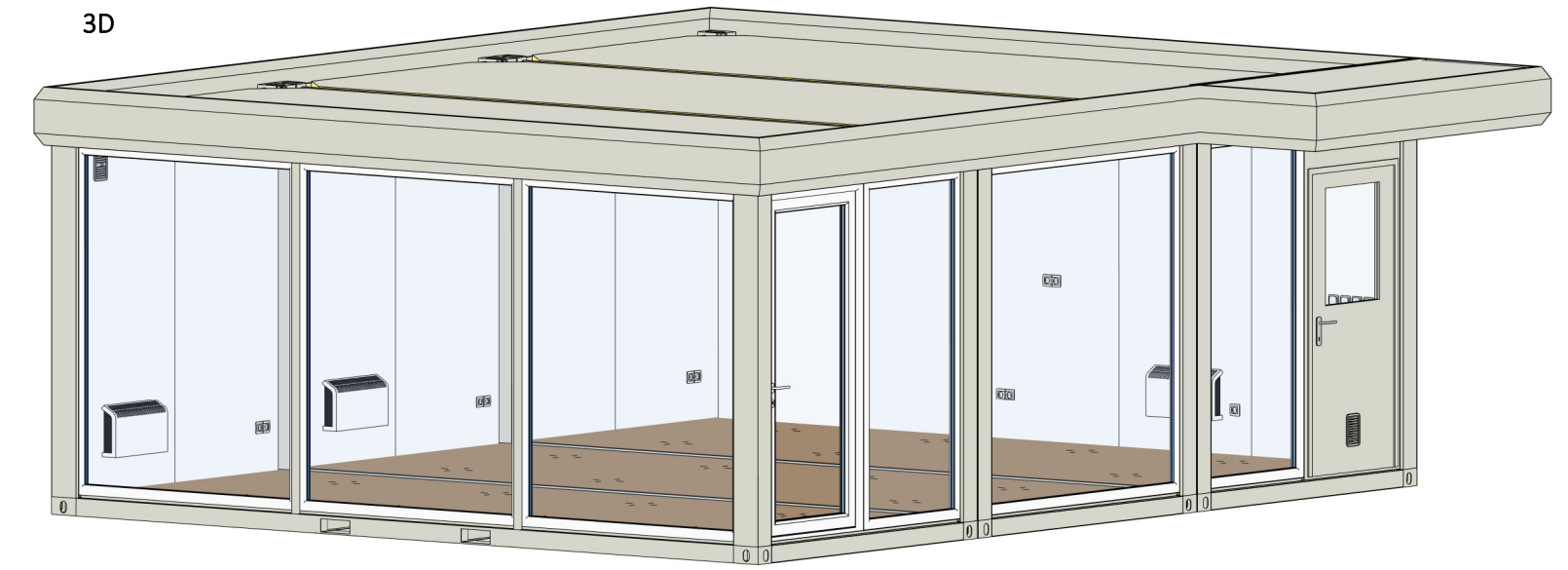

Floor plate  
Chipboard

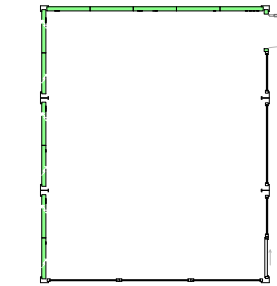

Floor covering  
/

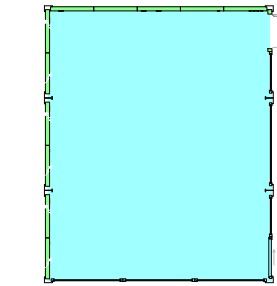

Ceiling covering  
Chipboard white

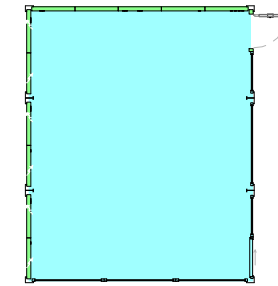

Inner wall color  
Chipboard white

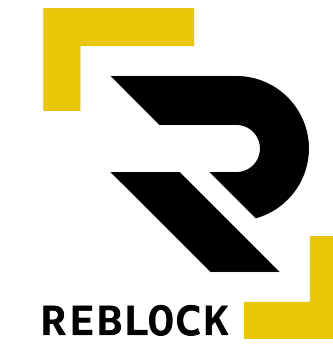

WWW NO  
KONTOR-LAGER-WC-AGGREGATOR

Pos.	Title	NET Dim.	Dim.	Material	Pcs.
D105	Door single AL(EPS), R	805x2000	905x2060	AL	1
D610	Glass facade with door, R	960x2295	1100x2395	PVC	1
W901	Glass facade FIX, FIX		x2395	PVC	6

Light type		Pcs.
☼	LED-spot	24
☼	Eco LEX LED 10W	1
Electrical equipment		Pcs.
⚡	Double socket in ceiling	1
⚡	Heater el. 2kW	3
⚡	Socket Double IP20	6
⚡	Socket IP20	3
⚡	Switch IP20	4
Panel Type		Insulation Stk.
■	FTVL-100 [9002/white]	100mm 12

Interior Height  
1:50

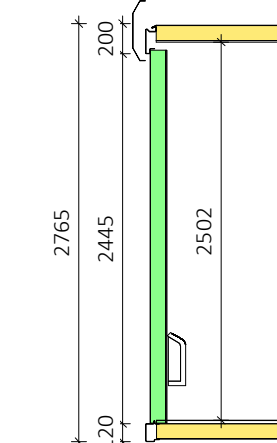

Customer:	Drwg. Nr.: N-91686-18-01	Labels Plumbing System	Rcontainer AS
Drwg. name: Plan with views	Version.: 01	Electric Type	/
Object: Ctn Compound	Scale: As indicated	Forklift	230V, 50Hz (NO) 250x90-1200mm
Ref. number: N-91686-18	Designed:	Roof Insulation	100mm
Date: 27.2.2018	Approved:	Floor Insulation	100mm
		Frame Galvaniz.	/
		Frame Colour	RAL 9002
		Interior Height	2,5m
		Export of CTN	Assembled